

AVIA PROPELLER Ltd Beranových 65/666 199 00 Praha 9 Czech Republic	SERVICE ADVISORY SA-13A	DOA No. EASA.21J.072
---	--------------------------------	-----------------------------

SUBJECT:

This document describes the alternative method of connecting brush block assembly P/N:066-5300, as a replacement for brush block assembly P/N:P3560-7, where there are not 4 conductors leading from the timer to the brush block, but only 2.

CONTENTS:	Page:
I. GENERAL	1
II. NOMENCLATURE	1
III. LIST OF TOOLS	2
IV. CONNECTING CABLE	2
V. INSTALLING CONNECTING CABLES ONTO BRUSH BLOCK ASSEMBLY	3

I. GENERAL

- A. Brush block assembly replacement is not considered as periodic maintenance. It is carried out only in case of damage, or malfunction of the original brush block assembly.
- B. In addition to this document use Propeller Installation and operational manual E-1500.
- C. The user is responsible for maintaining the current status of this document according to the changes made. A valid revision of this document is freely available at www.aviapropeller.com.

II. NOMENCLATURE

The **brush block assembly** consists of a Brush assembly, bracket and fasteners.

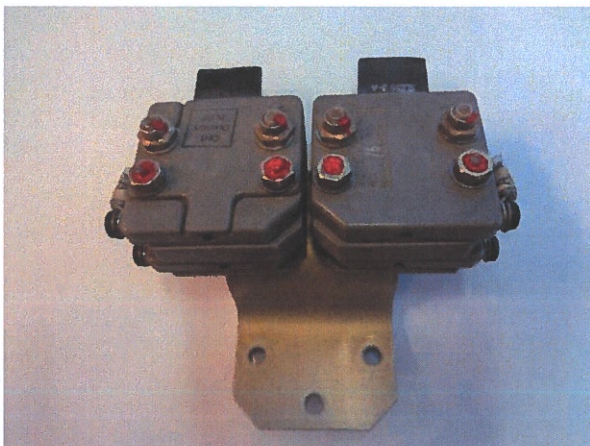

Fig.1 Brush block assembly P/N:066-5300

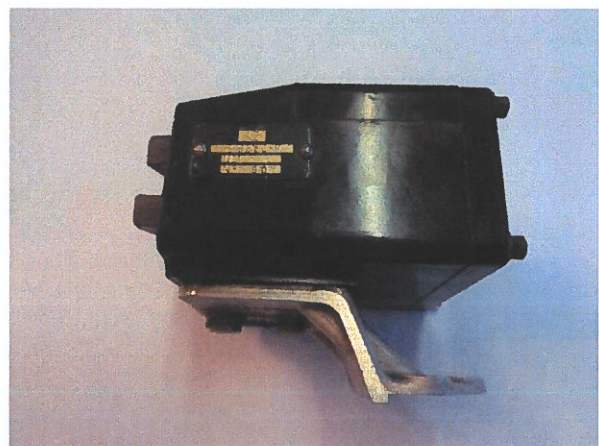

Fig.2 Brush block assembly P/N:P3560-7

The technical content of this document is approved under authority of DOA No. EASA.21J.072.

Office of Airworthiness Zbyněk Tvrdík <i>Tvrdík</i> Date: November 25, 2020	Prepared by: <i>Demkovič</i> Pavel Demkovič Date: November 25, 2020		Page: 1 Pages: 3
---	---	--	-------------------------

Replaces edition of November 8, 2017 (13) ; Change No.R-117/20

The connecting cable consists of a cable and ring terminals.

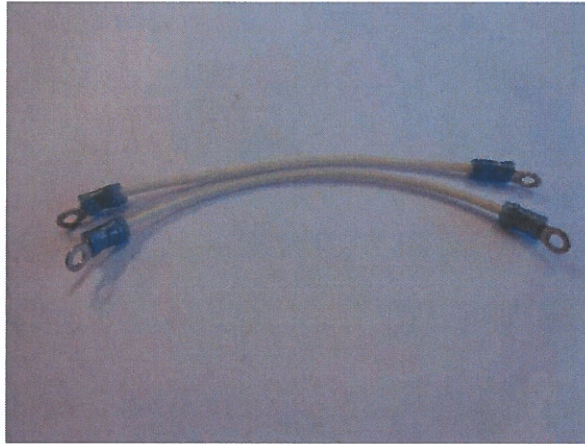

Fig.3 Connecting cables P/N:300-753

III. LIST OF TOOLS

Cross screwdriver - type PH2 for disassembly/assembly of safety screws in the brush blocks.
Crimping tool for crimping the ring terminal onto connecting cables.

IV. CONNECTING CABLE (P/N:300-753)

We need 2 connecting cables to connect the brushes of the brush block. The cables should not have a diameter smaller than 1.5mm^2 (e.g. SiFF 45505 from the company Helukabel) and the ring terminals should be suitable for the specific diameter of the used cable (e.g. P/N320619 from the company Tyco Electronics).

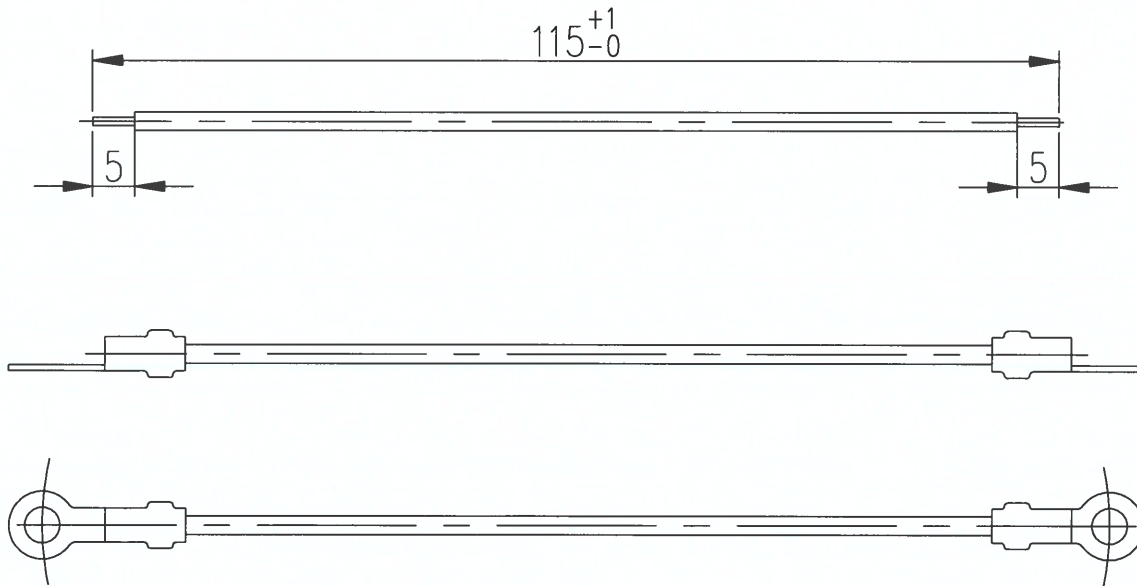

Fig.4 Connecting cables P/N:300-753 - preparation

The technical content of this document is approved under authority of DOA No. EASA.21J.072.

Office of Airworthiness Zbyněk Tvrdík <i>Tvrdík</i> Date: November 25, 2020	Prepared by: <i>Demkovič</i> Pavel Demkovič Date: November 25, 2020	Page: 2 Pages: 3
---	---	---------------------

V. INSTALLING CONNECTING CABLES ONTO BRUSH BLOCK ASSEMBLY

Unscrew 4 screws from the brushes using a screwdriver. Insert ring terminals of the cables in a A-A and B-B sequence. Insert and tighten the removed screws.

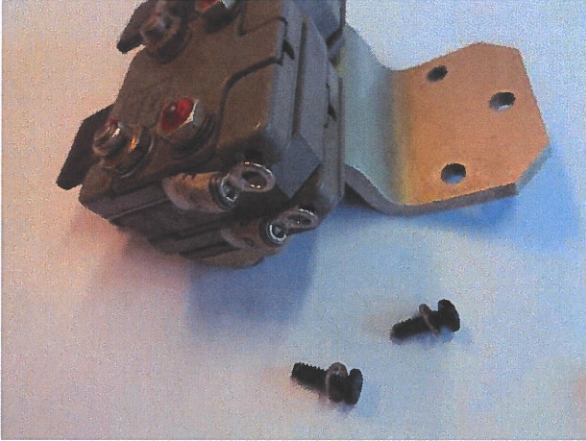

Fig.5 Removed screws

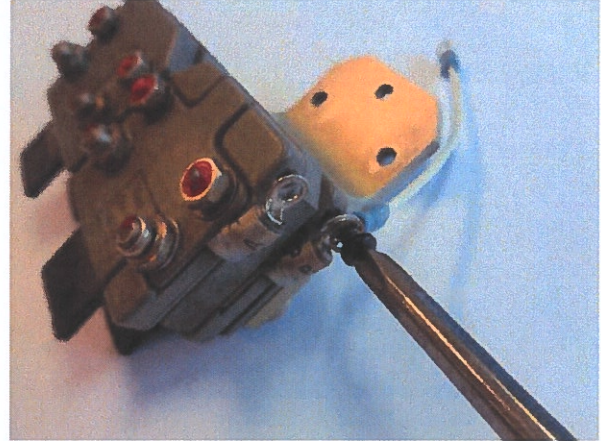

Fig.6 Installation of connecting cables

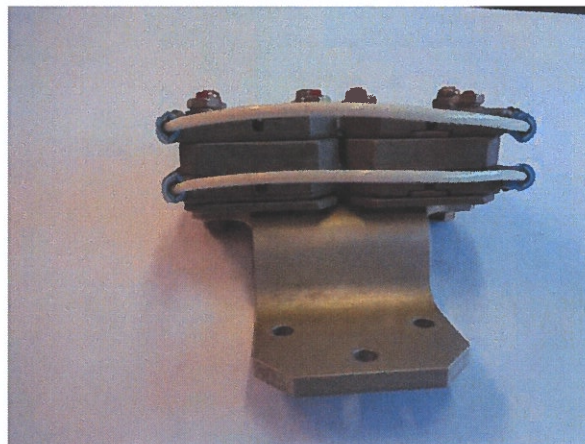

Fig.7 Brush block assembly P/N:066-5300 with connecting cables P/N:300-753

The technical content of this document is approved under authority of DOA No. EASA.21J.072.

Office of Airworthiness Zbyněk Tvrdík Date: November 25, 2020	Prepared by: Pavel Demkovič Date: November 25, 2020		Page: 3 Pages: 3
---	---	--	---------------------